

VTM-200-10
90 X 48 X 200 H cm

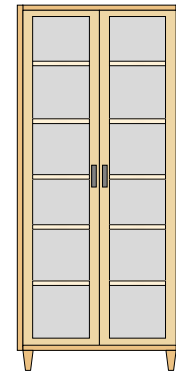

VTM-200-10P
90 X 48 X 200 H cm

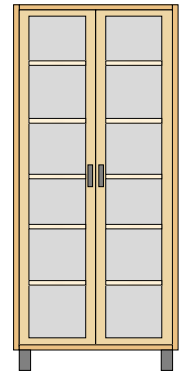

VTM-200-10T
90 X 48 X 200 H cm

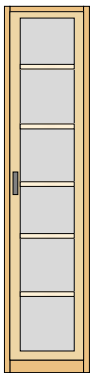

VTM-200-5
45 X 48 X 200 H cm

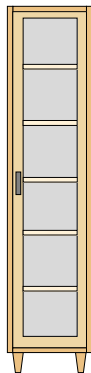

VTM-200-5P
45 X 48 X 200 H cm



VTM-200-5T
45 X 48 X 200 H cm

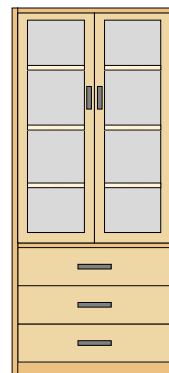

VTM-200-20
90 X 48 X 200 H cm

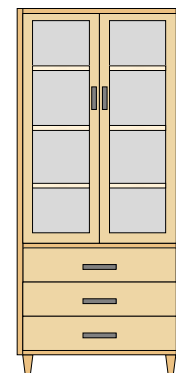

VTM-200-20P
90 X 48 X 200 H cm

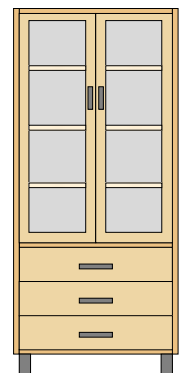

VTM-200-20T
90 X 48 X 200 H cm

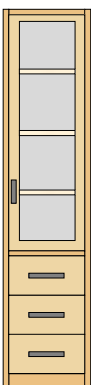

VTM-200-6
45 X 48 X 200 H cm



VTM-200-6P
45 X 48 X 200 H cm

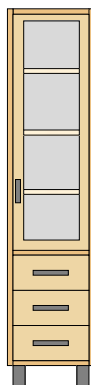

VTM-200-6T
45 X 48 X 200 H cm

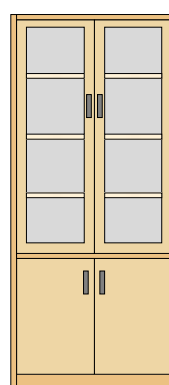

VTM-200-30
90 X 48 X 200 H cm

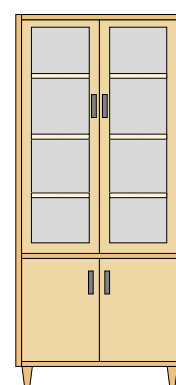

VTM-200-30P
90 X 48 X 200 H cm

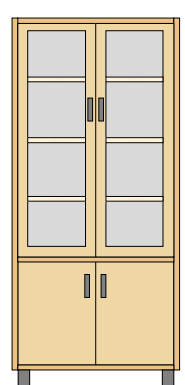

VTM-200-30T
90 X 48 X 200 H cm

Vitrina de dos metros de altura elaborada en tablero chapado en haya. Dos anchuras: 45 y 90 cm.

Con zócalo o patas en madera maciza de haya o patas metálicas.

Opcional:

- Cerraduras.
- Ausencia de tiradores.
- Posibilidad de fabricación personalizada, tanto en medidas como en distribución o acabados.